

Luckwell Road

BEDMINSTER

APPROXIMATE FLOOR AREA
98.4 SQM / 1059 SQFT



GROUND FLOOR
448 sq.ft. (41.6 sq.m.) approx.

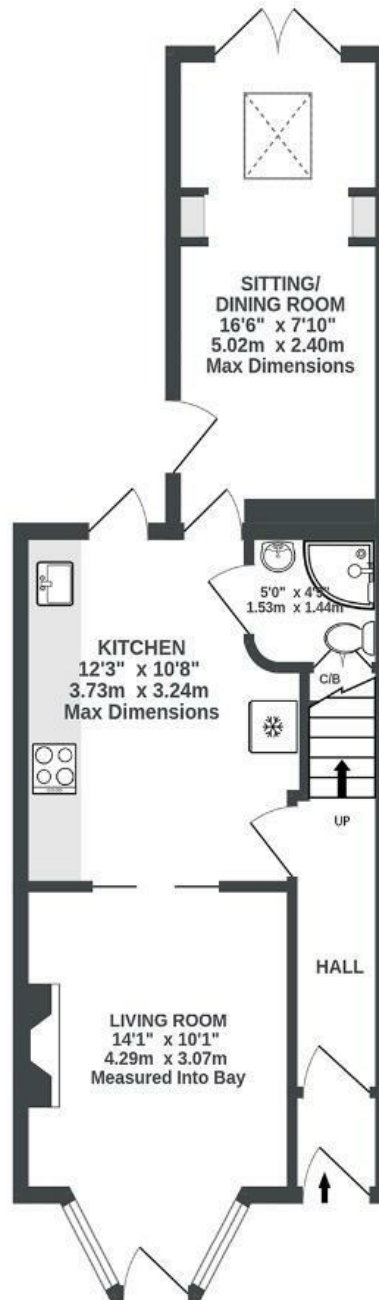

1ST FLOOR
422 sq.ft. (39.2 sq.m.) approx.

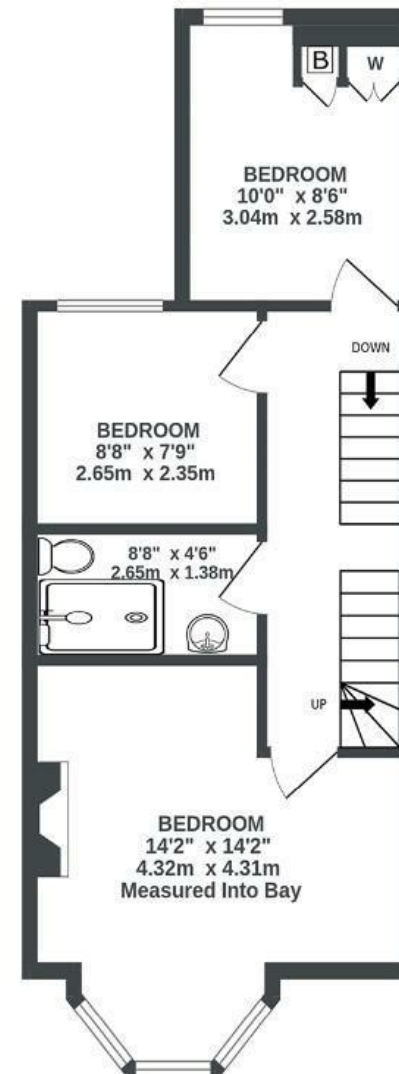

2ND FLOOR
189 sq.ft. (17.6 sq.m.) approx.

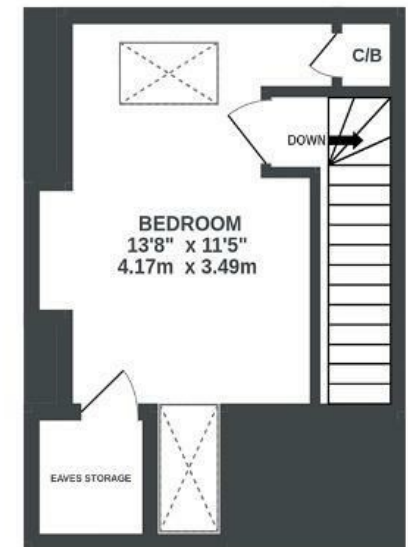

Illustrations are for reference purposes only, measurements are approximate, not to scale.

Boardwalk

Luckwell Road

ASHTON, BRISTOL

£

£475,000



BS3 3HB

zzz

4 Bedrooms



2 Bathrooms

"My home offers a real sense of calm. I worked with a great team and the natural materials, soft finishes and thoughtful design create a space that feels both grounded and welcoming. It holds warmth in every sense - peaceful to be in, full of character. There is a quiet quality to the light and acoustics that makes it an easy place to spend time relaxing and entertaining in."

